

Events



NEW BATH
HOTEL & SPA

A large, elegant event room with round tables, red chairs, a chandelier, and a whiteboard. The room is set up for a formal event, with several round tables covered in white cloths and surrounded by red upholstered chairs with gold frames. A large chandelier hangs from the ceiling, and a whiteboard is positioned at the front of the room. Large windows with light-colored curtains are on the right side, providing natural light. The room has a classic, historical feel with white walls and decorative paneling.

We're dedicated to ensuring every detail of your event is exceptional. We deliver a seamless experience within the authentic charm of our historical hotel. Our dedicated events executive will manage every element - ensuring everything runs flawlessly for a truly successful event.

We offer the inspiration and flexibility to help you create an event that's as seamless as it is memorable.



Venue

Set on the edge of the Peak District, New Bath Hotel & Spa offers a tranquil and inspiring setting for events. Our event spaces can accommodate a range of gatherings, from intimate birthday celebrations to parties and events.

With 54 stylish bedrooms, relaxing wellness facilities and a welcoming restaurant and bar, guests can unwind and recharge while enjoying the hotel's historic charm and landscaped grounds.

Conveniently located just 30 minutes from Derby and Sheffield, New Bath Hotel & Spa is perfectly placed for successful, memorable events.



A vibrant nightclub scene with people dancing under colorful lights. In the foreground, a woman in a shimmering sequined top and a man in a light blue shirt are dancing with their arms raised. The background is filled with other dancers and bright, colorful stage lights in shades of red, blue, and purple.

Party Package

£37.00 per person

Package Includes:

- Arrival drink for all guests
- Buffet dining, with a choice of finger buffet or hot fork buffet
- Exclusive use of a private function room
- Dancefloor
- Private bar, open and fully staffed throughout your event

Event timings: 6:00pm – 11:00pm

A minimum of 50 guests applies. Smaller numbers can be accommodated subject to a supplement.

Additional room hire and enhancement options are available on request (supplement applies).

Available seven days a week.

Event Package

£30.00 per person

Package Includes:

- A five-item finger buffet
- Tea and coffee service
- Private room hire

The package includes five hours of room hire.

A minimum of 20 guests applies.

Available seven days a week.





Celebration of Life

£24.00 per person

Package Includes:

- A selection of freshly prepared sandwiches and mini cakes
- Tea and coffee service
- Exclusive use of a private room

A minimum of 20 guests applies.

The package includes three hours of room hire, with the option to extend your time for an additional supplement, subject to availability.

Available seven days a week.

Venue Floor Plans

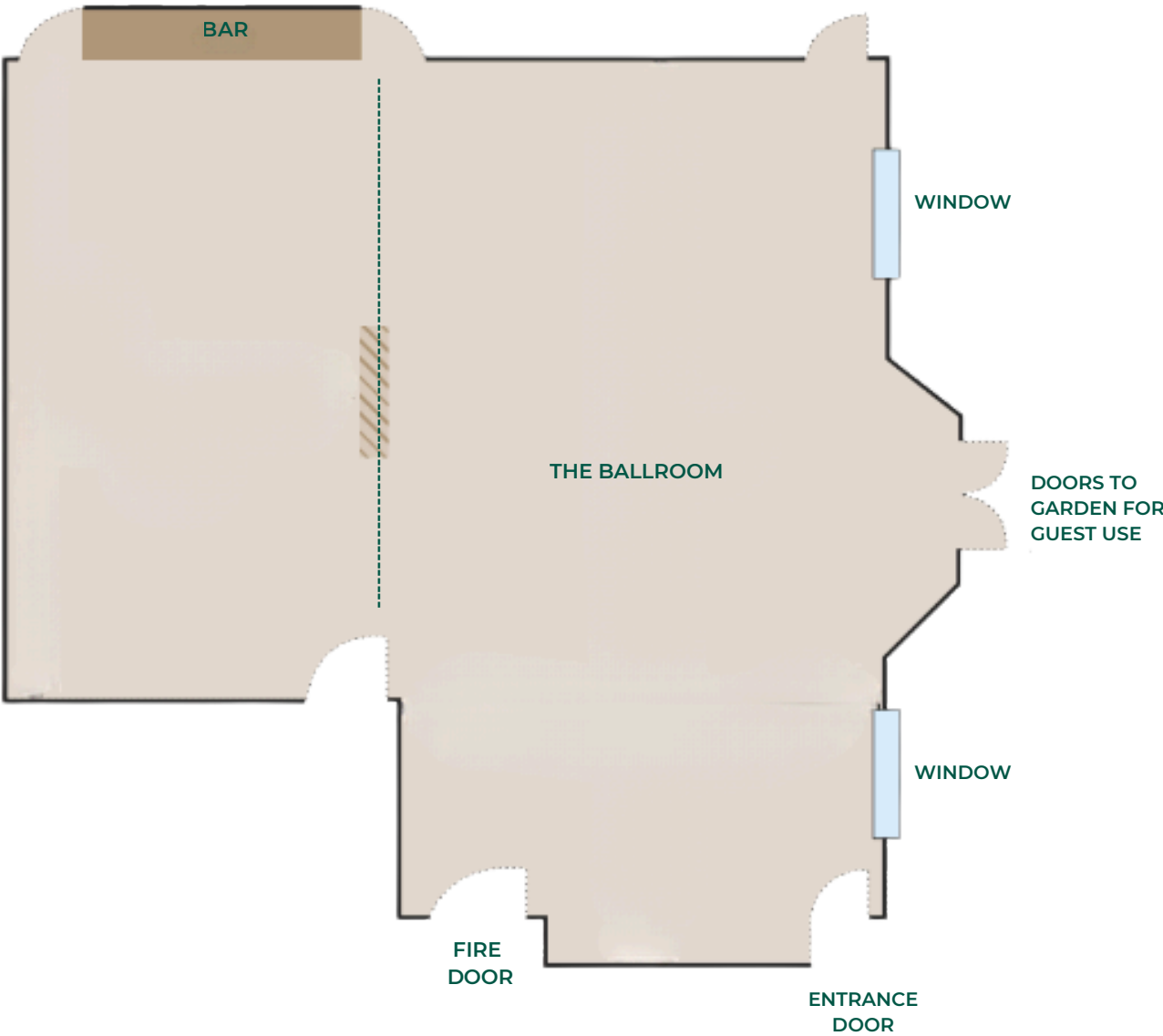
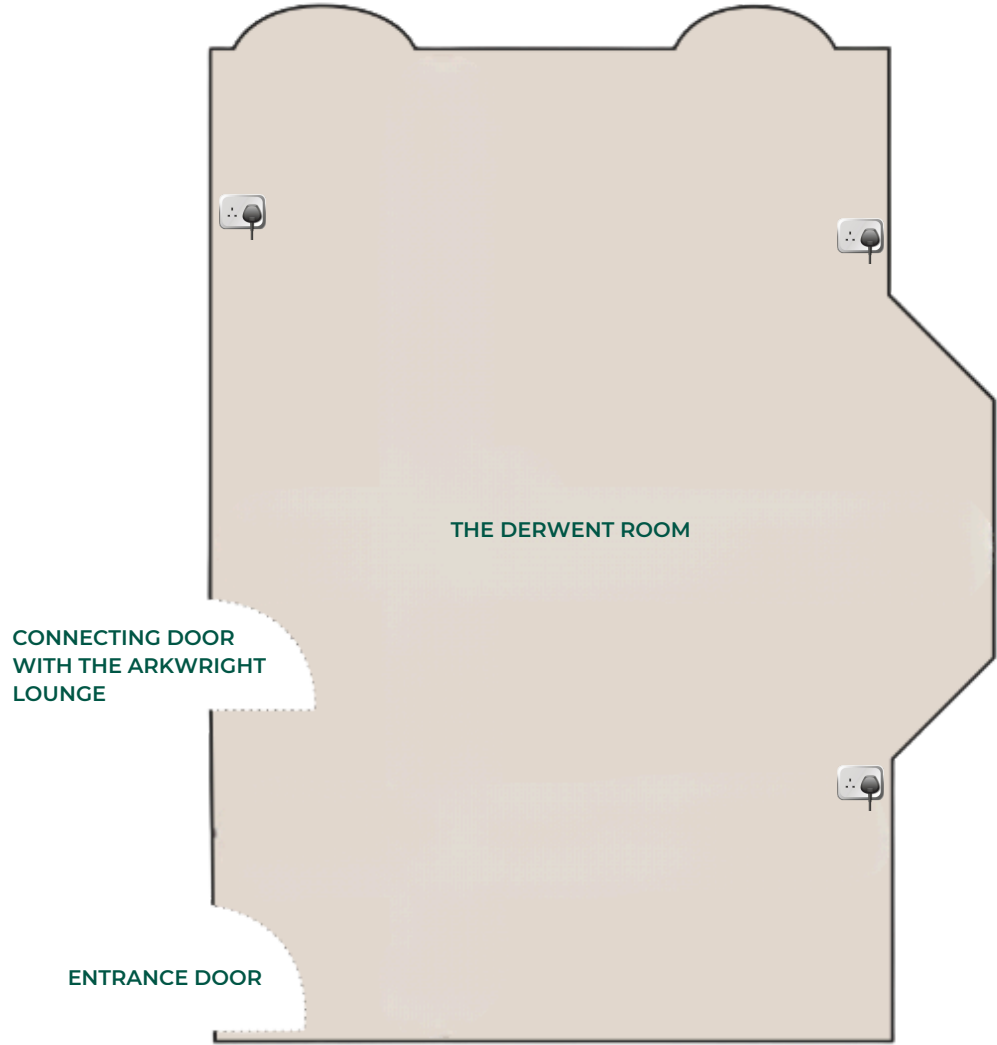



For further information on New Bath Hotel and Spa and to discuss your event requirements, please contact us.

Phone: 01629 340340

Email: sales@newbathhotelandspa.com

Address: New Bath Road, Matlock Bath, Derbyshire, DE4 3PX

By Road:

From the M1 (south): Take junction 28 and follow signs for the A623 towards Chesterfield/Matlock. Continue along the A623 through Matlock town center, following signs for Matlock Bath. The hotel is located in Matlock Bath, near the riverside.

From the M1 (north): Take junction 29 and follow signs for the A617 towards Chesterfield. Join the A6 towards Matlock, then follow signs for Matlock Bath. The hotel is situated in the heart of Matlock Bath, by the river.

By Rail: Matlock Railway Station, approximately 2 miles from the hotel, around 8 minutes by car.

By Air: East Midlands Airport, approximately 28 miles, around 50 minutes by car.

New Bath Hotel & Spa is a dog-friendly hotel.

We hope to
see you soon!